

Product description	<b>IP67, alternatively with surface as anti-twist protection</b>
Area	<b>Blind plug / Dummy plug</b>
Part no.	<b>08 3129 000 000</b>

Illustration

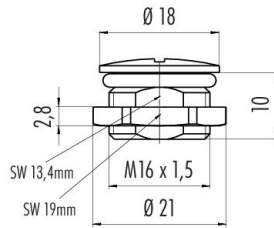

Scale drawing



Technical data

General features

Part no.	<b>08 3129 000 000</b>
Degree of protection	IP67
Thread	M16x1.5
Temperature range	-40 °C/+85 °C
Additional information	alternatively with surface as anti-twist protection
Weight (g)	19.30
Customs tariff number	85366990
Country of Origin	DE

Material

REACH SVHC	CAS 7439-92-1 (Lead)
SCIP number	f2ce2b78-f412-4381-9483-489d388819bd
Material	CuZn-Ni

Classifications

eCl@ss 11.1	27-44-02-08
ETIM 9.0	EC002314

Product description	<b>IP67, alternatively with surface as anti-twist protection</b>
Area Part no.	<b>Blind plug / Dummy plug 08 3129 000 000</b>

### Security notices

The connector must not be plugged or unplugged under load. Non-observance and improper use can result in personal injury.

The connectors have been developed for applications in plant engineering, control and electrical equipment construction. The user is responsible for checking whether the connectors can also be used in other areas of application.

Connectors which are used in circuits with voltages dangerous to the touch may only be installed and used by, or under the supervision of, persons with electrical engineering training, taking into account the applicable regulations and standards.

The user must take suitable safety precautions to ensure that the connector cannot be accidentally disconnected.

Plug connectors with enclosure protection IP67 and IP68 are not suitable for use under water. When used outdoors, the plug connectors must be protected separately against corrosion. For further information on the IP protection classes, please refer to the "Technical Information" download centre.

The plug connector is not suitable for mains voltages. Please observe the pollution degree and the overvoltage category. For further information, please refer to the download center "Technical Information".